

FT742-DM INSTALLATION

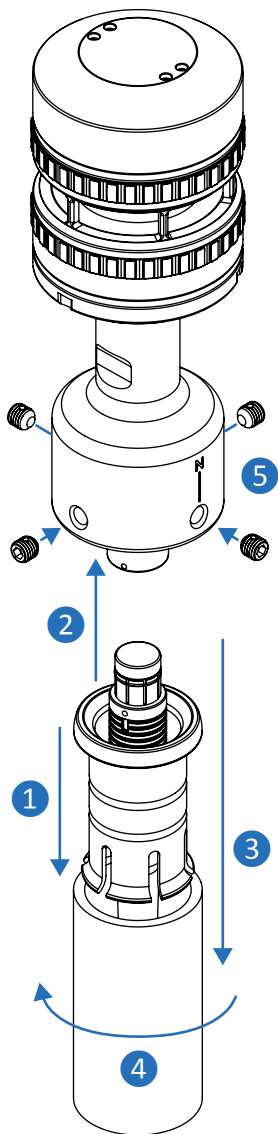

① - Fit the tapered pipe insert into the top of the pipe and fix into place with adhesive (not included).

② - Pass the cable through the pipe and attach it to the sensor.

③ - Slide the sensor firmly down over the pipe until it sits flat on the pipe.

④ - Rotate the sensor to align the datum (N).

⑤ - Tighten the mounting screws carefully to ensure an even distribution of pressure.

⑥ - For more information and guidance on installation in lightning and salt prone areas please consult the product manual.